

SHARP

DW-P22A

DEHUMIDIFIER OPERATION MANUAL

ENGLISH

中文

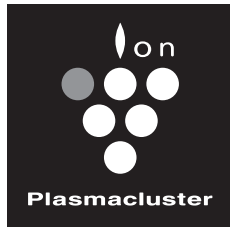

HIGH-DENSITY 7000 *

抽濕機 使用說明書

“Plasmacluster” and “Device of a cluster of grapes” are trademarks of Sharp Corporation.

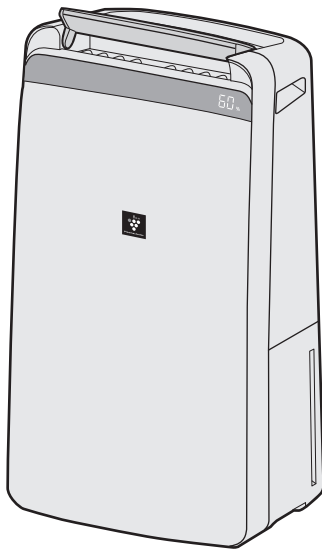

* The number in this technology mark indicates an approximate number of ions supplied into air of 1 cm³, which is measured around the center of a room with the “high-density plasmacluster 7000” applicable floor area (at 1.2 m height above the floor) when the product is placed close to a wall at the LAUNDRY Operation “DEODORIZE” mode setting.

Thank you for purchasing this SHARP Dehumidifier.
Please read this manual carefully before using the product.
This manual should be kept in a safe place for handy reference.

CONTENTS

IMPORTANT SAFETY INSTRUCTIONS	1
PART NAMES	3
PREPARATION	5
OPERATION	
START/STOP	5
DEHUMIDIFY OPERATION	5
HUMIDITY SELECTION	5
LAUNDRY OPERATION	6
INTERNAL DRY OPERATION	6
MOLD CONTROL OPERATION	6
SWING LOUVER	7
TIMER OPERATION	7
CHILD LOCK	7
HOW TO CHANGE VARIOUS SETTING	8
HOW TO DRAIN	9
CARE AND MAINTENANCE	10
TROUBLESHOOTING	11
SPECIFICATIONS	12

Dehumidify

In accordance with the principle of generating water droplets when warm air with much moisture gets contact with cold items, wet air is blown in a evaporator to remove moisture.

In the following cases, the compressor will stop and will not dehumidify.

- When the room temperature is lower than 4°C or higher than 38°C.
- The 3 minutes when the Main Unit operated again in the following to protect the Main Unit.
 - * Immediately after the power plug is inserted.
 - * Immediately after the Laundry Drying/ Dehumidifying operation is stopped.
- When the room temperature falls below 18°C, the compressor will stop and “HIGH” air flow mode will operate for about 12 minutes once every 45 minutes to prevent frost damage inside the Main Unit. (DEFROST mode / The DEFROST Indicator Light is turned on.)

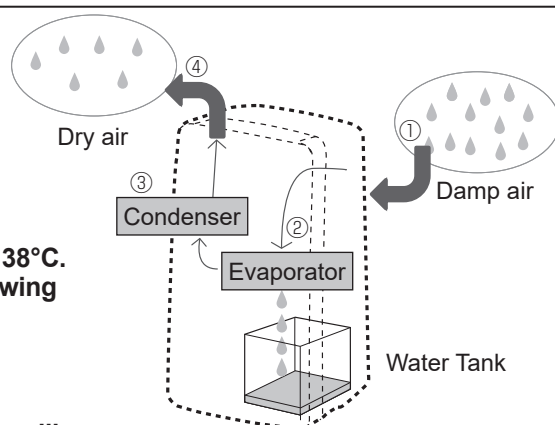



HIGH-DENSITY 7000 *

A powerful dehumidifier with a high concentration of Plasmacluster ions for cleaning, quick drying, and deodorizing room-dried laundry

MOLD CONTROL OPERATION

It prevents the propagation of the mold by releasing Plasmacluster and dehumidified air into the room.

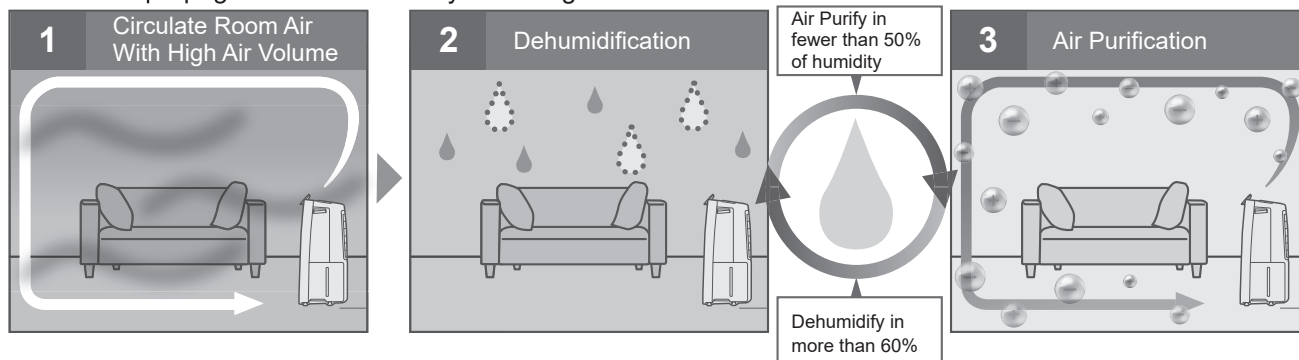

LAUNDRY Drying

Wide angle louver swings to both top and bottom / left and right wards and provides wide-area air flow.

MOLD Filter

It collects airborne mold through Mold filter and Pre-filter.

Large Tank 4.6L

It realizes continuous dehumidification. (more than approximate 6 hours.)

IMPORTANT SAFETY INSTRUCTIONS

Always follow **basic safety precautions** when using electrical appliances, including the following:

WARNING – Always observe the following to reduce the risk of electrical shock, fire, or injury:

- Read all instructions before using the Main Unit.
- Use only a 220-240 volt outlet.
- **This appliance is not intended for use by persons (including children) with reduced physical, sensory or mental capabilities, or lack of experience and knowledge, unless they have been given supervision or instruction concerning use of the appliance by a person responsible for their safety. Children should be supervised to ensure they do not play with the appliance.**
- **If the power cord is damaged, it must be replaced by the manufacturer, its service agent, a Sharp authorized Service Center or similarly qualified persons in order to avoid a hazard.**

- **Be sure to remove the power plug when draining the water, before performing maintenance, when removing and attaching and replacing the filter and when not using for a long time. Failure to do so can cause a short circuit resulting in electrical shock or fire.**
- Do not use the Main Unit if the power cord or plug is damaged or if the connection to the wall outlet is loose.
- Periodically remove dust from the plug.
- Do not insert fingers or foreign objects into the air intake or air outlet.
- When removing the power plug, always hold the plug and never pull on the cord. Failure to do so can cause a short circuit resulting in electrical shock or fire.
- When removing the Main Unit, do not damage the power cord with the casters. Failure to do so can cause electric shock, heat generation, or fire.
- Be careful not to damage the power cord, it may cause electric shock, excess heat or fires.

IMPORTANT SAFETY INSTRUCTIONS

- Do not remove the plug when your hands are wet.
- Do not place the Main Unit near gas appliances or fireplaces.
- Only a Sharp Authorized Service Center should service this dehumidifier. Contact the nearest Service Center for any problems, adjustments, or repairs.
- Do not operate the Main Unit in rooms where aerosol insecticides are present. Do not operate the Main Unit in rooms where there is oily residue, incense, sparks from lit cigarettes, or chemical fumes in the air. Do not operate the Main Unit in places where it may get wet, such as a bathroom.
- Be cautious when cleaning the Main Unit. Strong corrosive cleansers can damage the exterior.
- When carrying the Main Unit, first remove the Water Tank, and then hold the Main Unit by the handles on both sides.
- Do not drink the water in the Water Tank.
- Do not expose the Main Unit to water. Doing so can cause a short circuit or electrical shock.
- Clean the Water Tank regularly. When the Main Unit is not in use, dispose of the water in the Water Tank. Leaving water in the Water Tank can cause mold, bacteria, and bad odors. In rare cases, such bacteria can be a health hazard.
- Check for bent hose/falling height when you want to drain continuous, and place the hose where it will securely drain.
- Keep the temperature around the hose above freezing point when using the hose. Inner water may leak in the room and dampen the furniture or may cause electric shock/leakage, fire.
- Always operate the Main Unit in an upright position.
- When moving the Main Unit, use the handles on both sides. Do not move the Main Unit when it is in operation.
- If the Main Unit is on easily damaged flooring, an uneven surface, or thick-piled carpet, lift it up when moving.
- When moving the Main Unit by its casters, move it slowly and in a horizontal direction.
- Turn the Main Unit off and remove the Water Tank before moving, take care not to catch your fingers.
- Do not operate the Main Unit without the Water Tank properly installed.
- Clean the exterior with a soft cloth only. Do not use volatile fluids or detergents. The Main Unit surface may be damaged or cracked with Benzene paint thinner or polishing powder. In addition, the sensors may malfunction as a result.
- Keep the Main Unit away from water.
- Be sure to wipe off any excess water on the outside of the Water Tank.
- Do not shake the Water Tank with holding the carrying handle.
- Avoid spilling water when removing or cleaning the Water Tank.
- Do not remove the Float.
- Do not use the detergents for maintenance of the Water Tank and Tank Cover. If cause deformation, tarnishing, cracking (water leakage).
- Do not scrub the Back Panel hard during its maintenance.

NOTE - What to do if the Main Unit interferes with radio or TV reception.

If the Dehumidifier interferes with radio or television reception, try one or more of the following measures:

- Adjust or reposition the receiving antenna.
- Increase the distance between the Main Unit and the radio or TV.
- Connect the equipment into an outlet on a circuit different from that of the radio or TV receiver.
- Consult the dealer or a qualified radio or TV technician.

CAUTIONS CONCERNING OPERATION

- Do not block the air intake or air outlet.
- Do not place the Main Unit near or on hot objects, such as stoves or heaters, or where it may come into contact with steam.

INSTALLATION GUIDELINES

- Avoid locations where the sensors are exposed to direct wind. Doing so can cause the Main Unit to malfunction.
- Avoid locations where furniture, fabrics, or other objects can come in contact with the Main Unit and interfere with the intake and outtake of air.
- Avoid locations where the Main Unit is exposed to condensation or drastic changes in temperature. Appropriate room temperature is between 4 - 38°C.
- Place the Main Unit on a level and stable surface with sufficient air circulation. When placed on heavy carpet, the Main Unit may vibrate slightly. Place the Main Unit on a level surface to avoid water leakage from the Water Tank.
- Avoid locations that generate grease or oily smoke. Doing so can cause the Main Unit exterior to crack and the sensors to malfunction.

PART NAMES

MAIN UNIT

(FRONT)

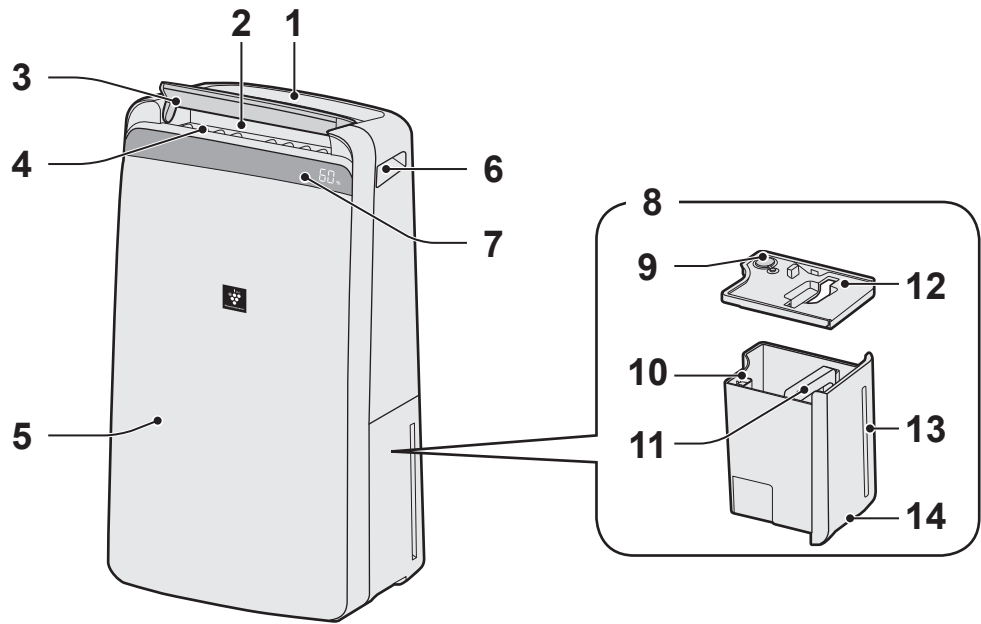

(BACK)

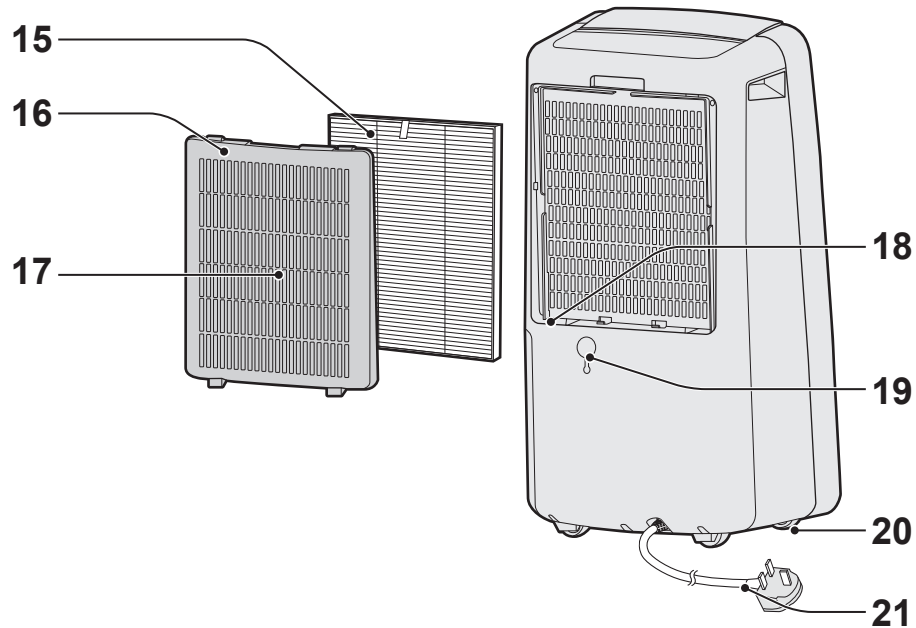

1	Operation Panel	12	Tank Cover
2	Air Outlet	13	Water Level Window
3	Vertical Louver	14	Tank Knob
4	Horizontal Louver	15	Mold Filter
5	Main Unit	16	Back Panel (Pre-Filter)
6	Handle (2 Locations)	17	Air Inlet
7	Front Display	18	Temperature/Humidity Sensor
8	Water Tank	19	Drainage Hole, Rubber Cap
9	Drain Outlet	20	Caster (4 Locations)
10	Float	21	Power Cord, Plug
11	Tank Handle		

PART NAMES

OPERATION PANEL

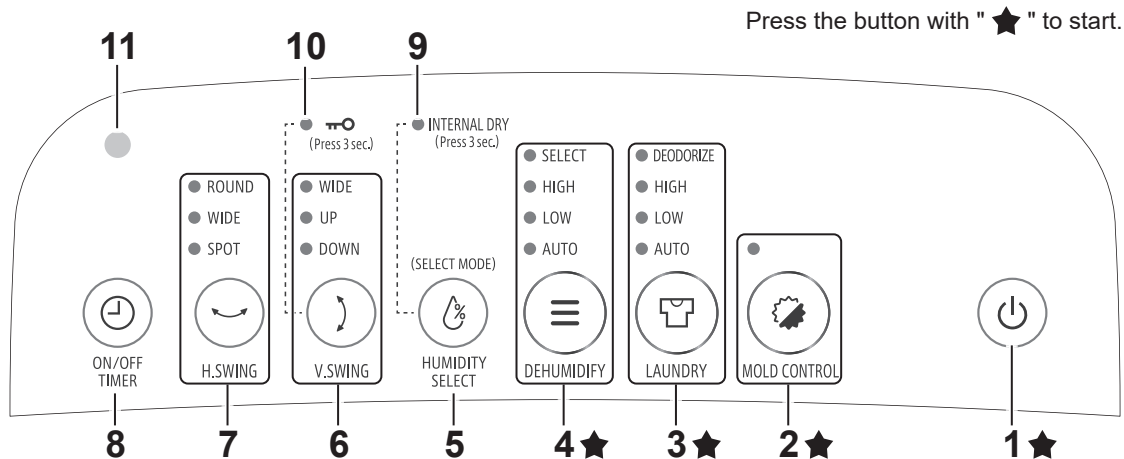

1	Power ON/OFF Button	7	H.SWING Button, Indicator Light
2	MOLD CONTROL Button, Indicator Light	8	ON/OFF TIMER Button
3	LAUNDRY Button, Indicator Light	9	INTERNAL DRY Indicator Light
4	DEHUMIDIFY Button, Indicator Light	10	Child-Lock Indicator Light
5	HUMIDITY SELECT Button	11	Light Sensor
6	V.SWING Button, Indicator Light		

FRONT DISPLAY

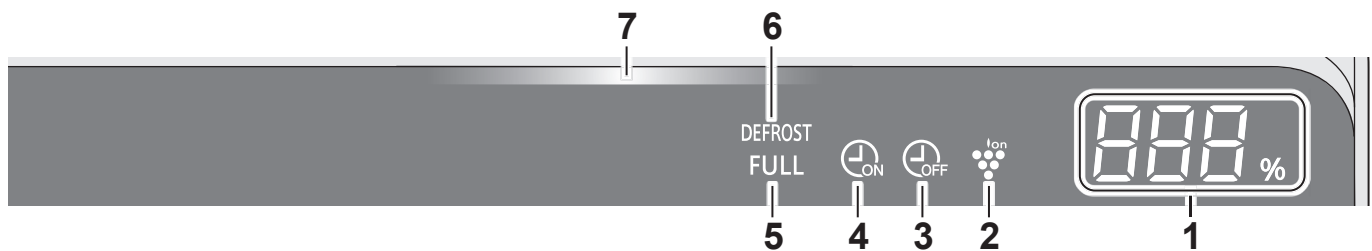

1	Humidity Monitor Indicates the approximate humidity level in the room. Humidity 20% to 90% is displayed. 20% or less 20% ↔ 55% ↔ 90% 90% or more	2	Plasmacluster Ion Indicator Light (Blue)
		3	OFF Timer Indicator Light
		4	ON Timer Indicator Light
		5	Tank FULL Indicator Light (Red) Blinking when the Water Tank is Full.
		6	DEFROST Indicator Light Indicates the Main Unit operates the DEFROST mode.
		7	MOLD CONTROL Sign Indicates the operation mode of the MOLD CONTROL operation.
	Timer Monitor Indicates setting time or remaining time of ON/OFF timer. HUMIDITY SELECT Monitor Indicates setting humidity of HUMIDITY SELECT mode.		

PREPARATION

FILTER INSTALLATION

1. Remove the Back Panel.

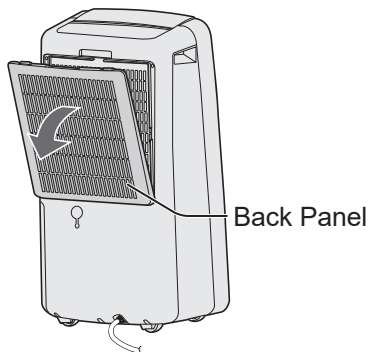

2. Remove the plastic bag from the Mold filter.

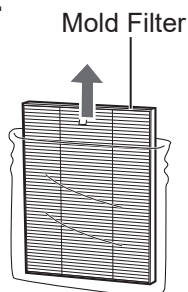

3. Install the Mold filter in the correct.

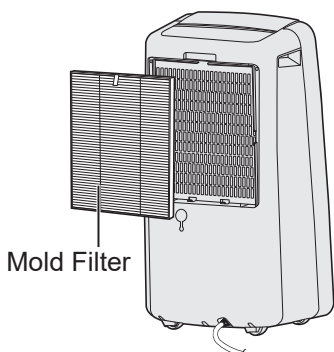

4. Install the Back Panel.

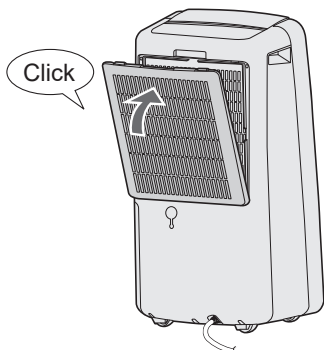

OPERATION

START / STOP

START



STOP

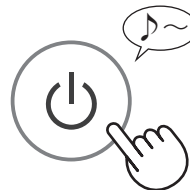

AUTO OFF Function

The operation will stop automatically after 12 hours in case the Main Unit has been forgotten to be turned off.

When you want to run the Main Unit for more than 12 hours continuously or drain water continuously, turn off the Auto Off function. (Page 8)

The operation is not stopped while operating with "Deodorization operation".

DEHUMIDIFY OPERATION

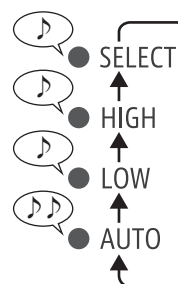

AUTO :

The humidity and the fan speed are automatically controlled by the "temperature and humidity sensor".

Temperature	4-26°C	26-38°C
Humidity	60%	55%

SELECT :

You can select your favorite humidity. (See below)

HUMIDITY SELECTION

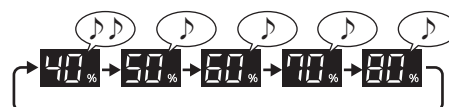

When you press the DEFUMIDIFY button to set SELECT mode, target humidity level can be changed to cycle among 60%, 70%, 80%, 40% and 50%RH in sequence.

* HUMIDITY SELECT can be works only when in SELECT mode.

OPERATION

LAUNDRY OPERATION



DRY(AUTO) :

When you want to dry with less power consumption, the Main Unit will repeat the Dehumidifying operation and the Air Flow mode to dry the laundry.

DEODORIZE :

When you want to deodorize your laundry, the Main Unit operates at "HIGH" fan speed. Make sure the air blowing out from air outlet is directed to your laundry. You cannot select the Plasmacluster Ion "OFF".

INTERNAL DRY OPERATION

When you set the Internal Dry operation, the Main Unit automatically operate the Air Flow mode for approximate 90 minutes after stopping.

(with the Main Unit ON)

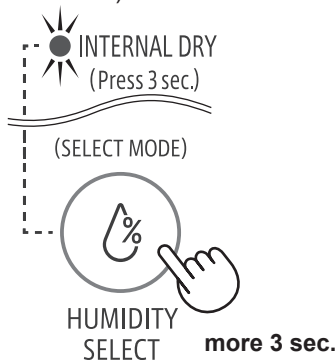

MOLD CONTROL OPERATION

This mode is used to suppress the mold through strong air flow with Plasmacluster Ion.

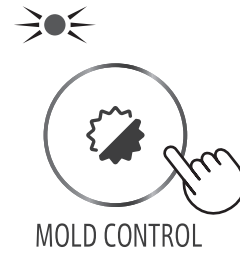

When turned ON, it firstly starts ventilation for 10 minutes with maximum air flow, and then repeats following operation.

(MOLD CONTROL Sign shows actual operating mode. Purple: high air volume, Blue: low air volume.)

It operates automatically the Plasmacluster Ion "ON".

In a high humidity

It operates in "HIGH" mode of dehumidification until the humidity of the room decreases to the level which the mold less likely appears.



In a low humidity

Once the humidity in room becomes low, the model switches the operation with maximum airflow.

【 for about 80 minutes 】

(MOLD CONTROL Sign : blinking with Purple)

※Operating time depends on the room environment, usage conditions, and location of the Main Unit.

NOTE

- When the humidity becomes low, the main unit operates with "Low" air flow.
(MOLD CONTROL Sign : lighting in Blue)
If the humidity becomes high again, it will switch to the above operation under the condition of "in a high humidity".

SWING LOUVER

VERTICAL SWING

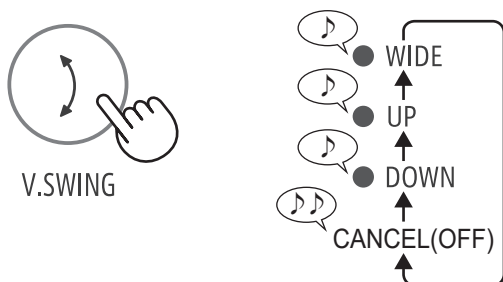

	DRY, DEODORIZE	DEHUMIDIFY
WIDE		
UP		
DOWN		

HORIZONTAL SWING

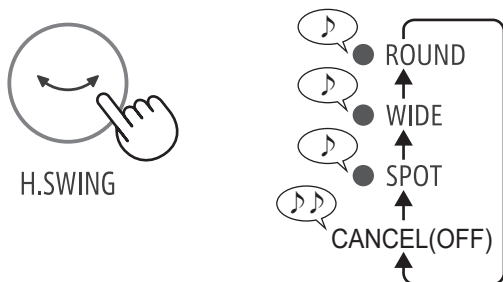

	DRY, DEODORIZE	DEHUMIDIFY
ROUND		
WIDE		
SPOT		

TIMER OPERATION

ON TIMER

The Main Unit automatically starts once the selected time passes.

(with the Main Unit OFF)

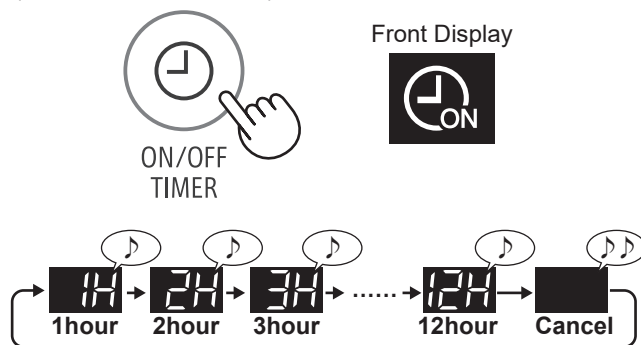

After 8 seconds, the beep sounds.

OFF TIMER

The Main Unit automatically stops once the selected time comes.

(with the Main Unit ON)

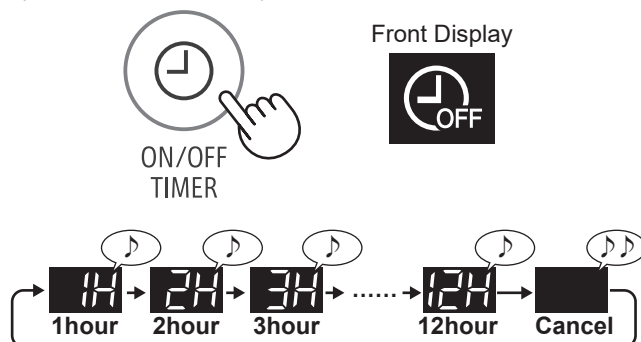

After 8 seconds, the beep sounds.

CHILD LOCK

The operation of the operation panel will be locked.

ON



CANCELLATION



OPERATION

HOW TO CHANGE VARIOUS SETTING

You can change the functions in the table "Type of setting".

1. Turn off the Main Unit power.



3. Select "Function number".

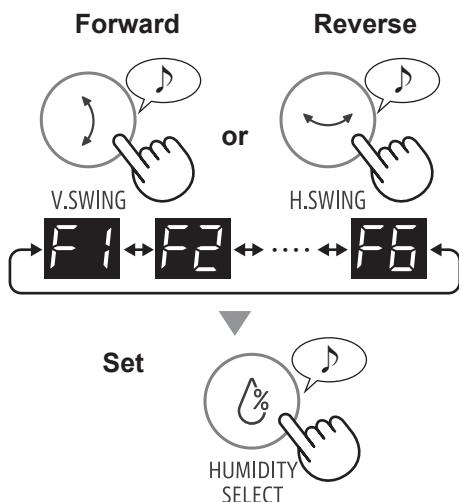

4. Select "Setting number".

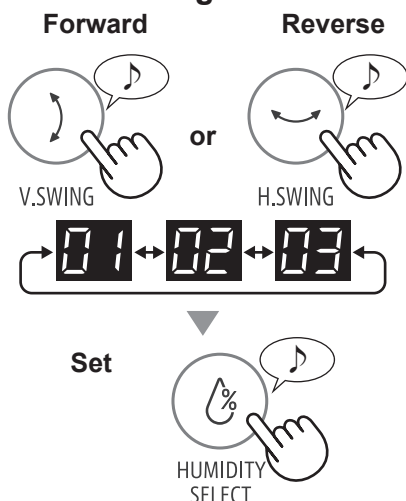

5. Press Power ON/OFF Button to finish the setting mode.



Type of setting

Function	Setting						
Auto Restart If the Main Unit is unplugged or if there is a power failure, the Main Unit will resume operation with the previous settings after power is restored.	01 Cancellation 02 ON (default)						
Sound Indicator Setting You can turn off the beeping sound when the Main Unit stops operating as follows. When the Main Unit stops operating as the following situation, you can turn off the beeping sound.	01 Cancellation 02 ON (default)						
Light Control You can select the brightness of the Front Display.	01 Turn off When set to "Turn off", the "Darker" light illuminates for 8 seconds after operation starts and then the light turns off. The FULL Light flashes darker only when the Water Tank is full. 02 Darker 03 Auto (default) Light automatically switches based on room brightness. <table border="1"> <tr> <th>Room</th><th>Front Display</th></tr> <tr> <td>bright</td><td>brighter</td></tr> <tr> <td>dark</td><td>darker</td></tr> </table> * When "SLEEP" mode operate; Room is bright : light is darker Room is dark : light is OFF	Room	Front Display	bright	brighter	dark	darker
Room	Front Display						
bright	brighter						
dark	darker						
PLASMACLUSTER ION ON/OFF	01 OFF 02 ON (default)						
Auto Off The operation will stop automatically after 12 hours in case the Main Unit has been forgotten to be turned off.	01 Cancellation 02 ON (default)						
Adjusting Sensor Sensitivity Light Sensor	01 Low 02 Standard (default) 03 High						

HOW TO DRAIN

When the Water Tank is Full, the TANK FULL Indicator Light is blinking.



1. Remove the Water Tank.

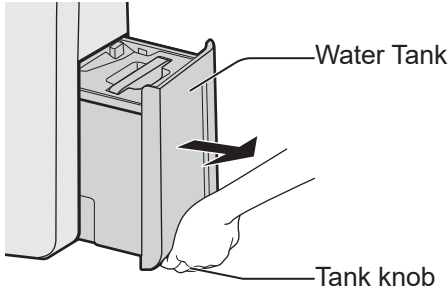

2. Dispose the water of the Water Tank.

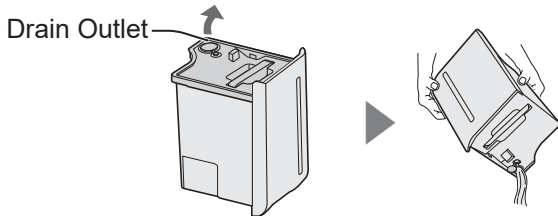

3. Install the Water Tank.

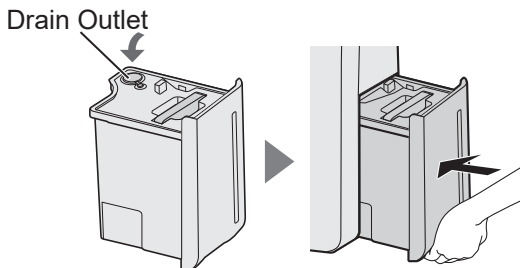

NOTE

- Clean the Water Tank about once a week. If you do not clean the Water Tank, it can cause mold, bacteria, and bad odors.

When you want to drain continuous

How to pipe the hose

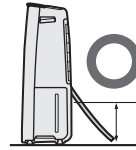

Always have the tip slanted.

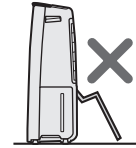

Do not bend.

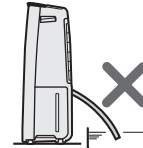

Under cold weather, do not put the hose into the water.

1. Remove the Plug.



2. Remove the Water Tank and the Rubber Cap.

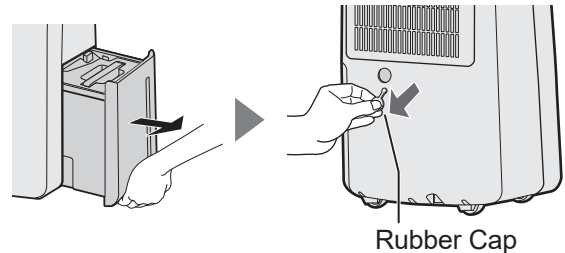

3. Set the hose in the Back Hole.

Commercial hose :
inner diameter 15mm
(outer diameter up to 21mm)

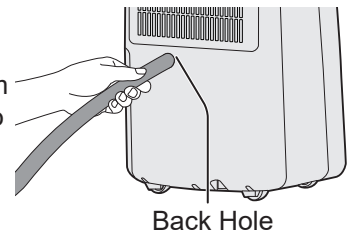

4. Insert the hose firmly to bottom in the Drain Hole.

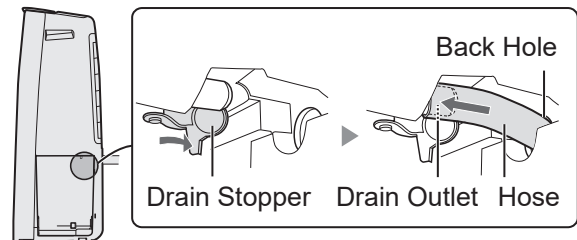

5. Install the Water Tank.

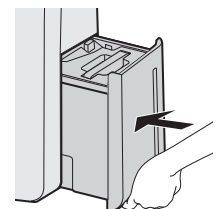

CARE AND MAINTENANCE

Water Tank (About once a week)

1. Remove the Tank Cover, and dispose of the water.

Tank Cover

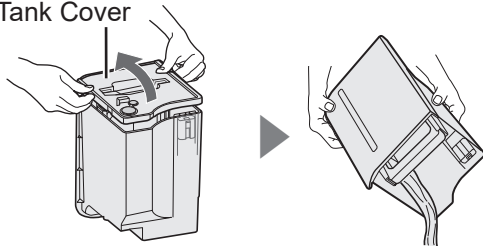

2. Wash the inside of the Water Tank.



NOTE

- If the dirt is heavy, please dissolve neutral detergent in lukewarm water and wash.

3. Dry the tank with a soft cloth.



Check the float.

4. Install the Tank Cover.

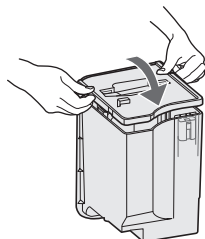

MAIN UNIT (About once a month)

Wipe with a dry, soft cloth.



Do not wash with water.

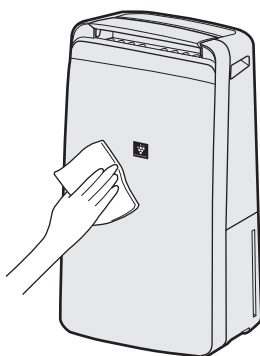

BACK PANEL / SENSOR (About once every 2 weeks)

Remove the dust gently with a cleaning tool such as a vacuum cleaner.

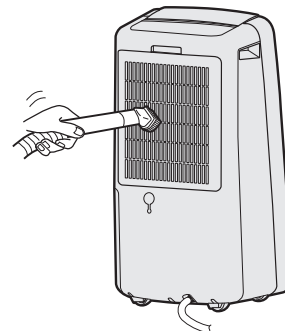

NOTE How to clean and remove a heavy dirt.

Back Panel

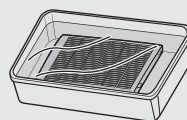

1. Add a small amount of neutral detergent to water and soak for about 10 minutes.

CAUTION

- Do not give excessive pressure to the back panel when scrubbing it.
2. Rinse off the neutral detergent with clean water.
3. Completely dry the filter in a well-ventilated area.

MOLD FILTER (About once a month)

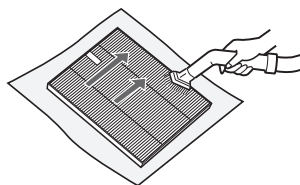

Remove the dust on the Mold Filter.

The filter is fragile, so be careful not to give too much pressure.

CAUTION

Do not wash the filter. Do not expose to sunlight. (Otherwise the filter may lose efficacy.)

FILTER REPLACEMENT

LIFE OF FILTERS

Filter life varies depending on the room environment, usage conditions, and location of the Main Unit. We recommend replacing the filter more frequently if the Main Unit is used in conditions significantly more severe than a normal household.

- Mold Filter About 1 years after opening

Replacement Filter Model

Consult your dealer when purchasing a replacement filter.

Mold Filter(1 unit)

FZ-J27KFE

Disposing of filter

Dispose of used filter according to local laws and regulations.

Mold Filter material:

- Polypropylene
- Polyethylene

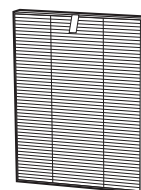

TROUBLESHOOTING

When storing for a long period (not in use)

1. Operate the INTERNAL DRY OPERATION.

① Start operation.



② Select the Internal Dry Operation.

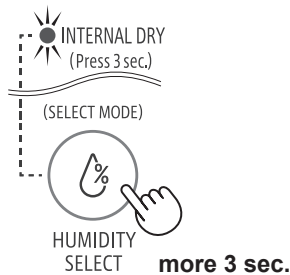

③ Stop Operation.



*Start the Internal Dry Operation, and stop automatically after approximate 90 minutes.

2. Dispose tank water and care the Main Unit.

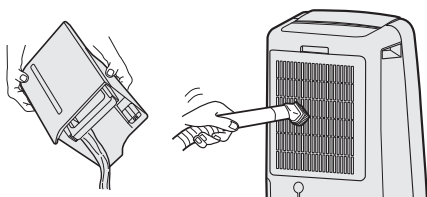

3. Store in a dry place away from direct sunlight.

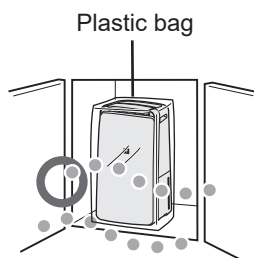

Before contact for service, check the following points to make sure that the problem is not a Main Unit malfunction.

The room becomes hot.

- The Main Unit generates heat during LAUNDRY DRY operation and DEHUMIDIFY operation and the room temperature will rise. Warm air will be come out from the air outlet, but this is normal and does not indicate a problem with the Main Unit.

The Main Unit does not dehumidify.

- The dehumidification level varies with the size, structure, temperature and humidity level of the room. When room temperature or humidity level is low, the dehumidification level will be low in general.
- Check whether the Back Panel is clean.
- Check whether the air outlet or air inlet is not blocked.

Sounds

- The Main Unit may make clicking or ticking sounds when it is generating ions.
- The Main Unit may seem rather loud for the first 2 to 3 minutes when the Main Unit is turned on. This is the sound of the compressor starting-up and is perfectly normal.
- A soft, swishing noise can be heard immediately after the Main Unit is turned on or off, and also during operation. This is the sound of the refrigerant flowing inside the Main Unit.

The sound is too loud.

- The Main Unit will sound loudly for the first few seconds upon power-on when the room temperature is low.
- Check whether the Main Unit is placed on a stable and level floor.
- Check whether the Back Panel is not clogged.

There is a discrepancy between the Main Unit's Humidity Monitor and another hygrometer in the room.

- There is a difference in the humidity level within the same room.
- The sensor have different measurement parameters.

The water leaks.

- Check whether the main unit is placed horizontally.
- When draining continuous, check whether the hose is inserted all the way seated.

ERROR DISPLAY

If error occurs repeatedly, contact the Sharp authorized Service Center.

	<ul style="list-style-type: none"> If the Water Tank is full, drain the water. If the Water Tank is not properly placed, place the Water Tank correctly.
	<ul style="list-style-type: none"> The Main Unit is operating with the DEFROST mode.
	<ul style="list-style-type: none"> Laundry DRY (Auto) operation has completed, and the operation has stopped.
	<ul style="list-style-type: none"> The operation has stopped with the Auto Off function.
	<ul style="list-style-type: none"> Unplug the Main Unit, wait one minute, and then plug the Main Unit in again.

SPECIFICATIONS

Model		DW-P22A
Power Supply		220V-240V/50Hz
Dehumidifying Capacity ※ 1	30°C/80%RH	22 L/day
	26.7°C/60%RH	13 L/day
Power Consumption ※ 2	30°C/80%RH	290 W
	26.7°C/60%RH	230 W
Standby Power ※ 3		0.7 W
Recommended Room Size for Dehumidifying ※ 4		27-54 m ²
Recommended Room Size for High density Plasmacluster ion ※ 5		33 m ²
Water Tank Capacity		Approx. 4.6 L
Cord Length		Approx. 2 m
Dimensions		359 mm(W) × 248 mm(D) × 665 mm(H)
Weight		16.0 kg

※ 1 The amount of humidity that a dehumidifier removes from the air in a day when room temperature and relative humidity are kept at 30°C/80%RH and 26.7°C/60%RH respectively.

※ 2 The consumption value when fan speed reaches the highest.

※ 3 When the Main Unit's power plug is inserted in a wall outlet it consumes the standby power in order to operate electrical circuits.

※ 4 Based on standards of JEMA.

※ 5 Recommended Room Size for High density Plasmacluster ion in which approximately 7000 ions per cubic centimeter can be measured in the center of the room when the Main Unit is placed next to a wall, is running at LAUNDRY Operation "DEODORIZE" mode settings, and is at a height of approximately 1.2 meters from the floor.

感謝購買 SHARP 抽濕機。

在使用本產品之前，請先詳細閱讀本使用說明書。

在閱讀後，請妥善保存本使用說明書，以便於日後有需要時查閱。

目錄

安全注意事項	1
部件名稱	3
使用前	5
操作方法	
運行開始 / 停止	5
除濕模式	5
濕度設定	5
乾衣除濕模式	6
內部除濕模式	6
抑菌防霉模式	6
搖擺送風	7
定時開 / 關機	7
兒童安全鎖	7
各種功能的變更設定	8
排水方法	9
保養與清潔	10
故障時的檢查事項	11
規格	12

除濕

根據高濕度的溫暖空氣接觸冰冷物品時會產生水滴的原理，將潮濕空氣吸入蒸發器中，去除水分。

在下列情況中，壓縮機將會停止，且不會除濕。

- 室溫低於 4°C 或高於 38°C 。
- 在下列情況中，主機會再次運行 3 分鐘，以保護主機。
 - * 插上電源插頭後立即運行。
 - * 在乾衣除濕 / 除濕模式停止後立即進行。
- 當室溫低於 18°C 時，壓縮機將會停止，且每 45 分鐘，會運行約 12 分鐘「強」風量模式，以避免主機內部受到結霜的傷害（除霜模式 / 除霜指示燈亮起）。

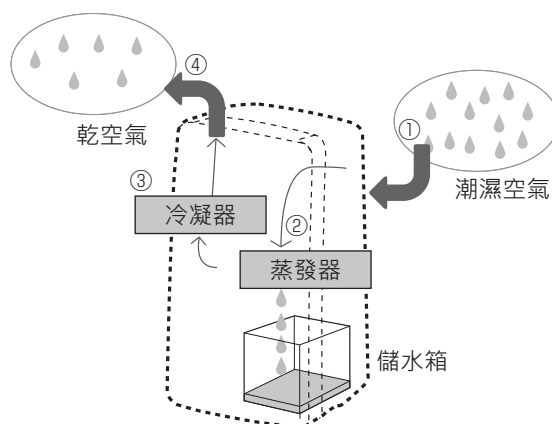



HIGH-DENSITY 7000 *

此款高效能的抽濕機配備高濃度 **Plasmacluster ions**，可淨化空氣、快速乾燥以及為室內晾乾之衣物除臭。

抑菌防霉模式

在房間釋放 Plasmacluster 及除濕空氣，以防止霉菌擴散。

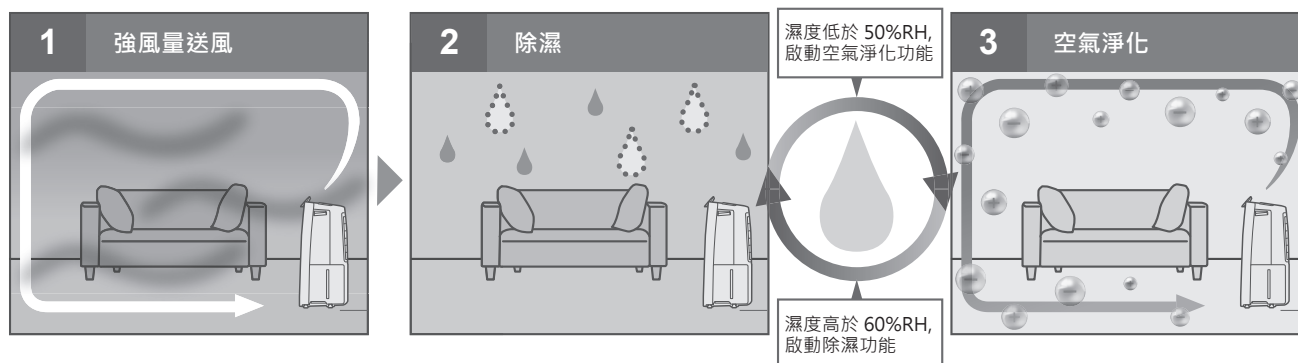

乾衣除濕

透過廣角導風板可以上下左右擺動，促使大面積的空氣流動，迅速乾燥衣物。

4.6L 大容量儲水箱

可持續除濕。(超過大約 6 小時。)

* 請參考封面的注釋。

霉菌過濾網

透過霉菌過濾網和前置過濾網收集空氣中的霉菌

安全注意事項

使用電器時，務必遵守以下各方面的基本安全預防措施，包括：

警告 - 請務必遵守下列事項，以降低觸電、火災或受傷風險：

- 在使用主機之前，請先閱讀所有注意事項。
- 僅能使用 220-240V 插座。
- 除在監護人或負責其安全人士的適當監督或指導下使用外，主機不適合身體機能或心智能力退化者，或缺乏操作經驗和知識的人士（包括兒童）使用。應適當監管兒童，確保不會玩弄此機器。
- 如果電源線損壞時，必須由製造商或其代理、SHARP 公司特約服務中心，或具有同等資格的人員負責更換，以免發生危險。

- 在進行排水、維護、拆卸、安裝及更換過濾網之前，以及長時間不使用時，請務必拔掉電源插頭，以避免可能會因為短路而導致觸電或引起火災。
- 如果電源線或插頭已損壞，或牆上的電源插座已鬆脫，請勿使用主機。
- 定期清除電源插頭上的灰塵。
- 請勿將手指或異物插入吸氣口或吹出口。
- 在拔掉電源插頭時，請務必緊握插頭拔出，絕不可拉扯電線，以避免可能會因短路而導致觸電或引起火災。
- 在移動主機時，請小心腳輪，勿損壞電源線，以避免可能會導致觸電、發熱或火災。
- 請小心不要損壞電源線，以免導致觸電、過熱或發生火災。

安全注意事項

- 請勿以潮濕的手拔除電源插頭。
- 請勿在氣體設備或壁爐附近使用主機。
- 此款抽濕機僅可由 SHARP 公司授權之服務中心進行維修。若主機出現任何問題、需要調校或修理，請聯絡客戶服務中心。
- 請勿在噴灑噴霧殺蟲劑後使用主機。請勿在有油性殘餘物、焚香、點燃香煙的火花、空氣中有化學煙霧的空間內使用主機。請勿在潮濕的環境（例如浴室）使用主機。
- 請注意在清潔主機時，具強力腐蝕性的清潔劑可能會損壞外殼。
- 在搬運主機時，請先取出儲水箱，並握住主機兩側的把手搬運。
- 切勿飲用儲水箱內的水。
- 切勿使主機接觸水源，以免可能會導致短路或觸電。
- 定期清潔儲水箱。在不使用主機時，請倒空儲水箱中的水，若不倒空可能會發霉、滋生細菌及產生惡臭，在少數情況下，此類細菌可能會損害健康。
- 如想要連續排水時，請先檢查彎曲軟管 / 排水的高度，並將軟管設置在安全排放位置。
- 在使用軟管時，請使軟管周圍的溫度保持在冰點以上。內部的水可能會流出至室內及弄濕家具，或導致觸電及火災。

注意 - 主機干擾收音機或電視接收時的相關措施。

如果本抽濕機對收音機或電視接收造成干擾時，請嘗試採取下列一項或多項措施修正干擾：

- 調整或重新放置接收天線。
- 增加主機與收音機或電視之間的距離。
- 將主機與收音機或電視接收器連接至不同電路的電源插座。
- 若需要協助，請諮詢經銷商或合格的收音機或電視技術人員。

操作注意事項

- 請勿堵塞吸氣口或吹出口。
- 請勿在熱源物體附近或在熱源物體上（例如爐灶或暖爐，或可能會接觸到蒸汽的場所）使用主機。

- 主機僅能直立使用，切勿平放。
- 在移動主機時，請緊握兩側的把手。切勿移動正在運行中的主機。
- 在易損、不平坦的地面及較厚的地毯上，應將主機抬起移動。
- 在推動腳輪，移動設備時，請以水平方向慢慢移動。
- 在移動之前，應先關閉主機及拆除儲水箱，請小心，不要夾傷手指。
- 在正確安裝儲水箱之前，切勿運行主機。
- 僅可使用柔軟的布清潔主機外部，切勿使用揮發性液體或清潔劑。苯塗料稀釋劑或拋光粉可能會損壞主機表面或使表面裂開，此外，亦可能會導致感測器發生故障。
- 請使主機保持遠離水源。
- 請務必徹底抹掉儲水箱外面多餘的水。
- 請勿握住把手搖晃儲水箱。
- 在拆卸或清潔儲水箱時，應避免水溢出。
- 請勿拆除浮板。
- 在保養儲水箱和儲水箱蓋時，請勿使用清潔劑，以免導致變形、變色、龜裂（漏水）。
- 在保養時，請勿用力擦洗背板。

安裝指南

- 請勿將主機(感測器)安裝在直接面對出風口的位置，以免可能會影響主機正常工作。
- 請避免在可能會與傢俱、織物或其他物品接觸的位置使用主機，以免可能無法確保吸氣口或吹出口暢通。
- 請勿在溫差極大，或會導致主機直接暴露於冷凝環境的位置使用。主機僅適合在 4 - 38°C 之間的室溫下使用。
- 安裝時必須穩固，且通風良好。將主機放置於鋪設厚地毯的位置，可能會導致主機微微震動。請將主機置於平整的表面，以避免儲水箱漏水。
- 請避免在會產生油脂或油煙的場所使用主機，以免可能會導致主機表面裂開以及感測器發生故障。

部件名稱

主機

(正面)

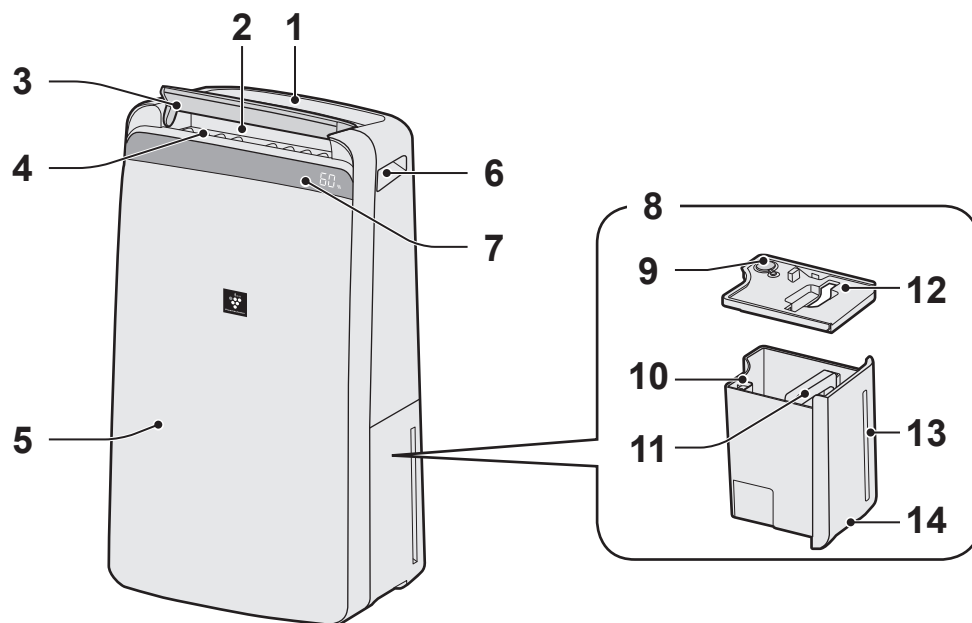

(背面)

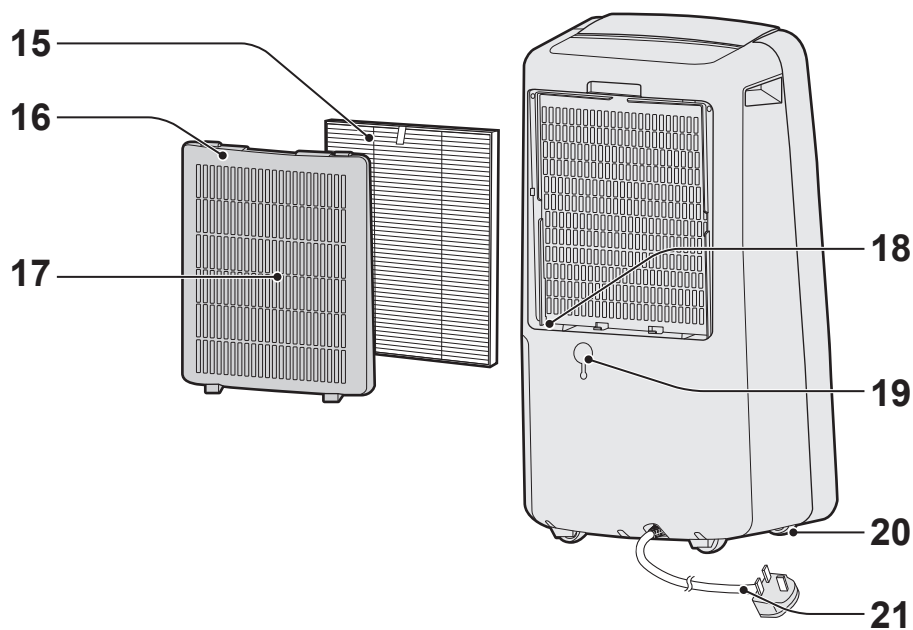

1	操作面板	12	儲水箱蓋
2	吹出口	13	水位窗
3	上下導風板	14	儲水箱拉槽
4	左右導風板	15	霉菌過濾網
5	主機	16	背板 (前置過濾網)
6	把手 (左右兩處)	17	吸氣口
7	顯示面板	18	溫度 / 濕度感測器
8	儲水箱	19	排水孔、塞頭
9	排水口	20	腳輪 (4個)
10	浮板	21	電源線、電源插頭
11	儲水箱手柄		

部件名稱

操作面板

按一下「★」的按鍵，以開始。

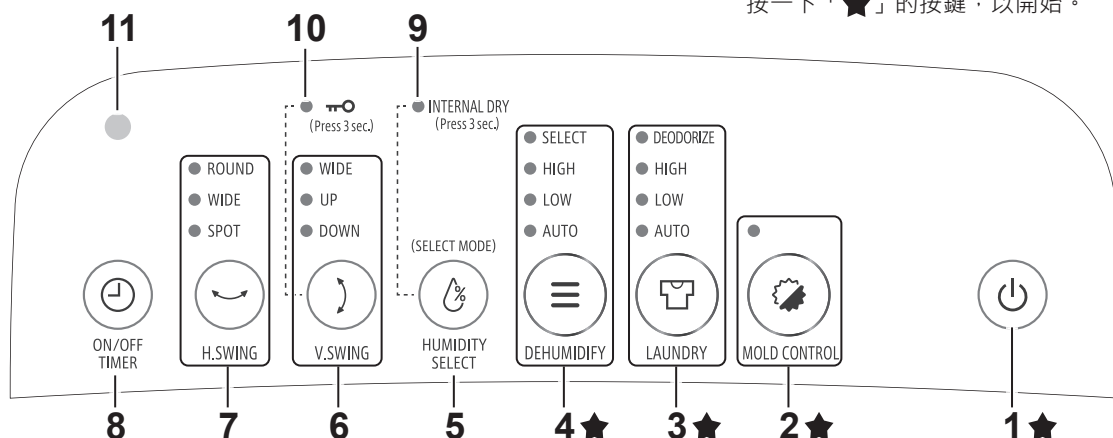

1	電源（開 / 關）按鍵	7	左右擺風按鍵、指示燈
2	抑菌防霉按鍵、指示燈	8	定時（開 / 關）按鍵
3	乾衣除濕按鍵、指示燈	9	內部除濕指示燈
4	除濕模式按鍵、指示燈	10	兒童安全鎖指示燈
5	濕度設定按鍵	11	亮度感測器
6	上下擺風按鍵、指示燈		

顯示面板

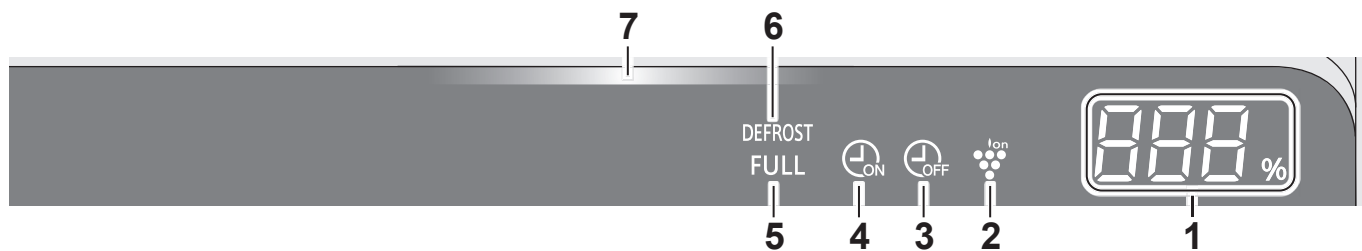

1	濕度偵測指示燈 說明房間內之濕度數值的近似值。 顯示 20% 至 90% 的濕度。 20% 以下 20% ↔ 55% ↔ 90% 90% 以上	2	Plasmacluster ion 指示燈（藍色）
	定時（開 / 關）指示燈 顯示定時（開 / 關）的設定時間或剩餘時間。	3	定時關機指示燈
	濕度設定 顯示濕度設定模式所設置的濕度。	4	定時開機指示燈
		5	滿水指示燈（紅色） 當儲水箱滿水時會閃爍。
		6	除霜指示燈 顯示主機在除霜模式下運行。
		7	抑菌防霉指示燈 顯示主機在抑菌防霉模式下運行。

使用前

安裝過濾網

1. 拆下背板。

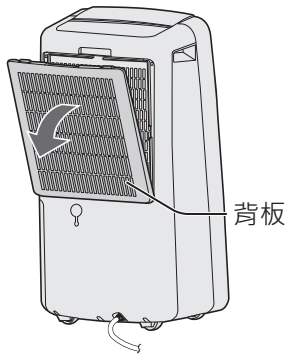

2. 拆下霉菌過濾網上的塑膠袋。

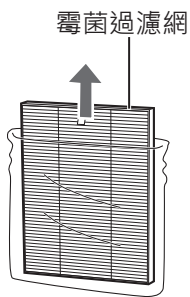

3. 正確安裝霉菌過濾網。

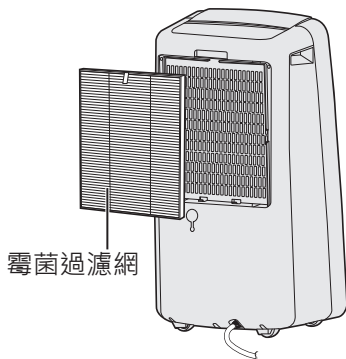

4. 安裝背板。

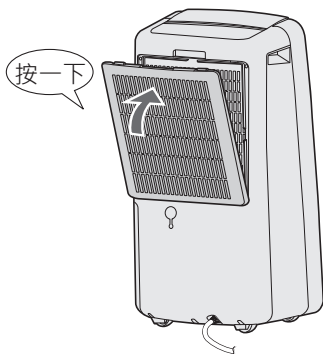

操作方法

運行開始 / 停止

運行

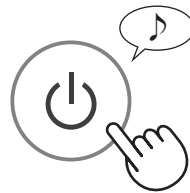

停止

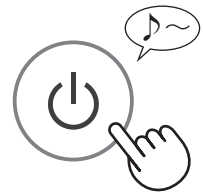

自動關機功能

如果忘記關閉主機時，將會在 12 小時後自動停止運行。

若想連續運行主機超過 12 小時或連續排水時，請關閉自動關機功能。（請參閱 第 8 頁）

除濕模式

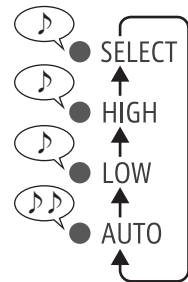

自動：

由「溫度 / 濕度感測器」自動控制濕度和風量。

溫度	4-26°C	26-38°C
濕度	60%	55%

自訂：

您可以選取喜愛的濕度。（請參閱下方）

濕度設定

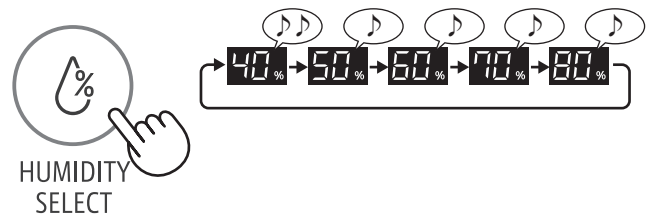

當您按下除濕模式按鍵，並設定自訂模式時，可將濕度數值更改為依序在 60%、70%、80%、40% 和 50%RH 之間循環。

* 僅有在自訂模式下，濕度設定才能有效運行。

操作方法

乾衣除濕模式



自動：

當您想要以低耗電量進行乾衣時，主機會重複進行除濕和送風模式，藉此烘乾衣物。

衣物除臭：

當您想要為衣物除臭時，主機會以「強」風量運行，確保從吹出口吹出的空氣會直接吹入您的衣物。
主機運行時，會「開啟」Plasmacluster ion 功能。

內部除濕模式

當您設定內部除濕模式時，主機會持續運行約 90 分鐘，自動以送風模式運行。

(主機開啟時)

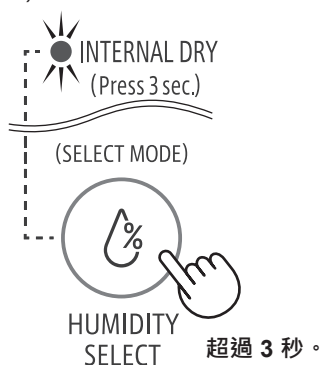

抑菌防霉模式

使用抑菌防霉模式，主機會透過強風量送風方式，將 Plasmacluster ion 擴散至房間的寬廣區域，以抑制霉菌。

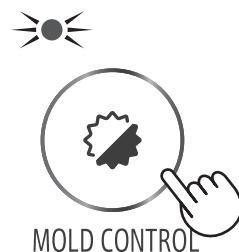

在開啟時，會先以強風量送風 10 分鐘，然後自動進行以下情況的運行。(抑菌防霉指示燈會顯示出實際的運行模式，紫色：高風量，藍色：弱風量。)

主機運行時會「開啟」Plasmacluster ion。

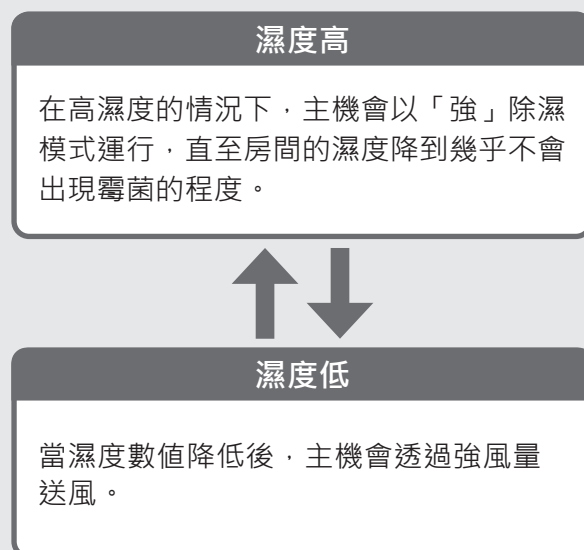

【大約 80 分鐘】[抑菌防霉指示燈：紫色 / 閃爍]
※ 運行時間會因使用方法及環境條件而有所差異

注意

• 室內濕度降低，主機會以弱風量運行。

[抑菌防霉指示燈：藍色 / 亮起]

若濕度上升時會再切換至高濕度情況的除濕模式。

搖擺送風

上下送風



	乾衣、除臭	除濕
廣域		
上		
下		

左右送風



	乾衣、除臭	除濕
廣域		
廣角		
集中		

定時開 / 關機

開機定時器

主機將會在選定的時間結束後自動啟動。

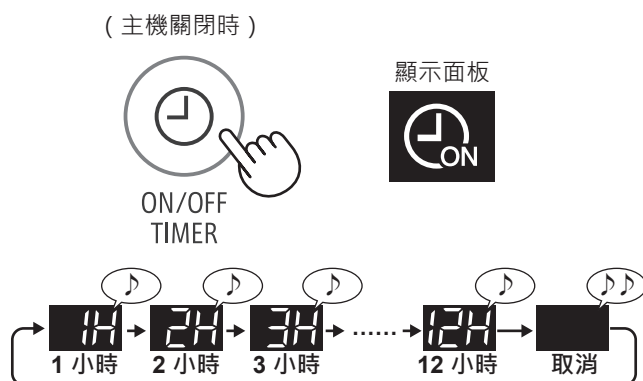

8秒後發出嗶聲完成切換。

關機定時器

主機將會在選定的時間到達時自動停止。

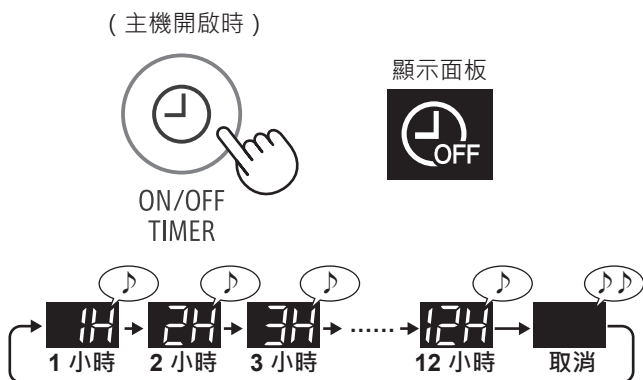

8秒後發出嗶聲完成切換。

兒童安全鎖

鎖定操作面板的操作。

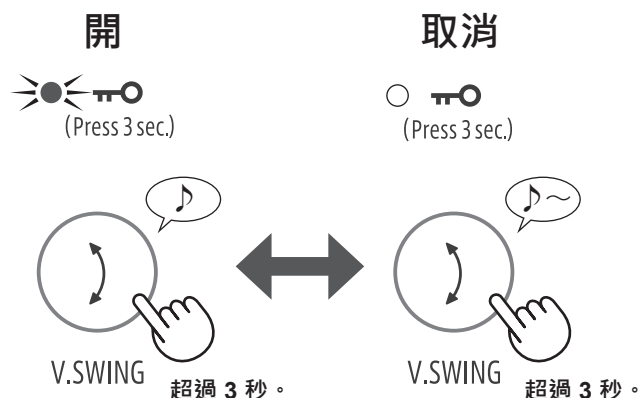

操作方法

各種功能的變更設定

您可以更改「設定類型」表中的功能。

1. 關閉主機電源。



3. 選取「功能號碼」。

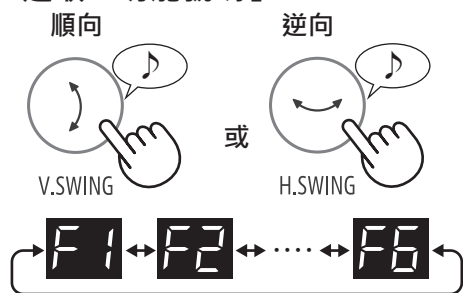

設定



4. 選取「設定號碼」。

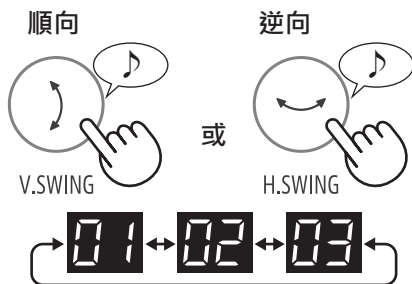

設定



5. 按下電源（開 / 關）按鍵，完成設定模式。



設定類型

功能	設定						
自動記憶功能 如果拔掉主機插頭或停電，則主機將會在電源恢復後以先前的設定繼續運行。	<div>01 取消</div> <div>02 開（預設）</div>						
關閉提示音 當主機停止運行時，可以關閉提示音。如下所示，在主機停止運行時，可以關閉提示音。	<div>01 取消</div> <div>02 開（預設）</div>						
亮度調教 您可以選擇顯示面板的亮度。	<div>01 關閉 當設定為「關閉」時，在操作開始後，「較暗」指示燈會亮起 8 秒鐘，然後熄滅。僅有在儲水箱滿水時，FULL(滿水)指示燈才會以較暗方式閃爍。</div> <div>02 較暗</div> <div>03 自動（預設） 會根據房間的亮度自動切換燈光。</div> <table border="1"> <tr> <td>房間</td><td>顯示面板</td></tr> <tr> <td>亮</td><td>較亮</td></tr> <tr> <td>暗</td><td>較暗</td></tr> </table> <p>* 當「睡眠」模式運行時， 房間明亮：燈光較暗。 房間較暗：燈光關閉。</p>	房間	顯示面板	亮	較亮	暗	較暗
房間	顯示面板						
亮	較亮						
暗	較暗						
Plasmacluster ion開 / 關	<div>01 關</div> <div>02 開（預設）</div>						
自動關機功能 如果忘記關閉主機時，將會在 12 小時後自動停止運行。	<div>01 取消</div> <div>02 開（預設）</div>						
調校感測器的靈敏度 亮度感測器	<div>01 低</div> <div>02 中（預設）</div> <div>03 高</div>						

排水方法

當儲水箱滿水時，滿水指示燈會閃爍。

FULL

1. 拆下儲水箱。

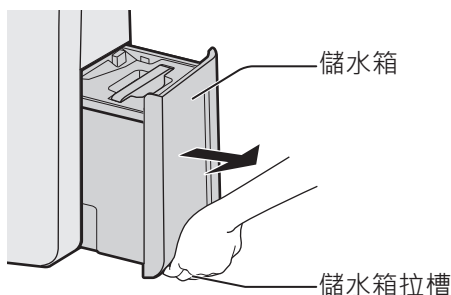

2. 倒掉儲水箱中的水。

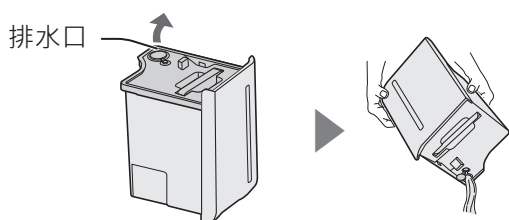

3. 安裝儲水箱。

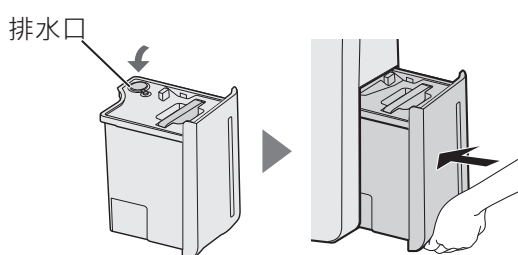

注意

- 每週清潔一次儲水箱。若未清潔儲水箱，則可能會發霉、滋生細菌及產生惡臭。

在想要連續排水時

如何使用軟管排水

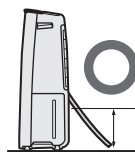

前端須向下傾斜。

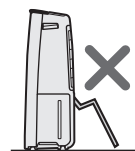

請勿彎曲。

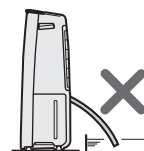

在寒冷的天氣下，請勿將軟管放入水中。

1. 拔下電源插頭。



2. 拆下儲水箱和塞頭。

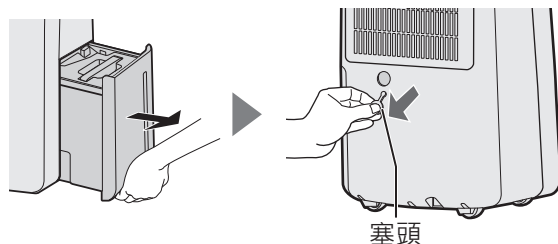

3. 將軟管接在排水孔上。

市售軟管：
內徑 15mm
(外徑可達 21mm)

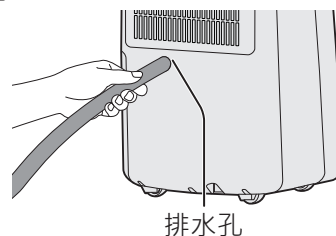

4. 將軟管穩固地插入排水孔底部。

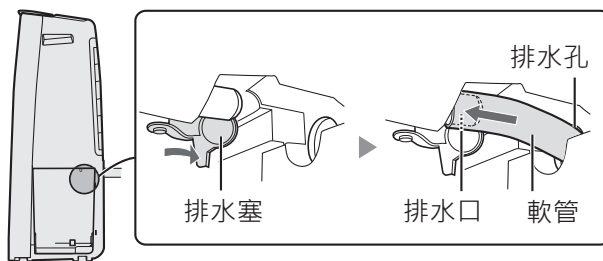

5. 安裝儲水箱。

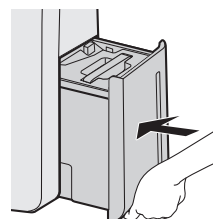

保養與清潔

儲水箱 (大約每週一次)

1. 拆下儲水箱蓋，將水倒掉。

儲水箱蓋

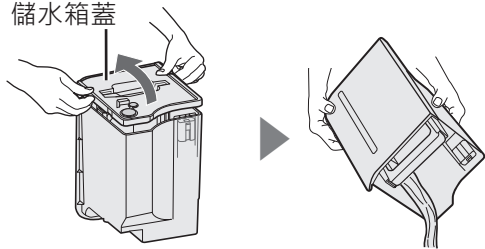

2. 清洗儲水箱內部。

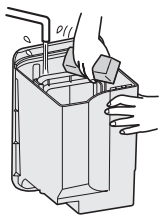

注意

- 如果過度髒污時，請將中性清潔劑溶於溫水中後進行清洗。

3. 使用軟布擦乾儲水箱。

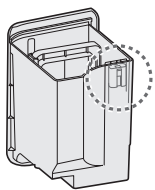

檢查浮板。

4. 安裝儲水箱蓋。

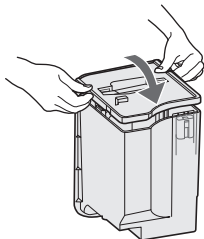

主機 (大約每月一次)

使用乾軟布擦拭。



請勿用水清洗。

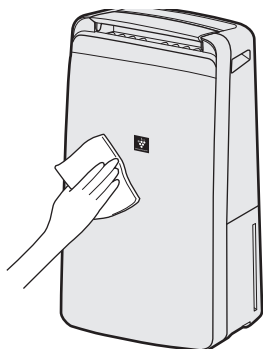

背板 / 感測器 (大約每 2 週一次)

使用清潔工具 (例如吸塵機) 輕輕除塵。

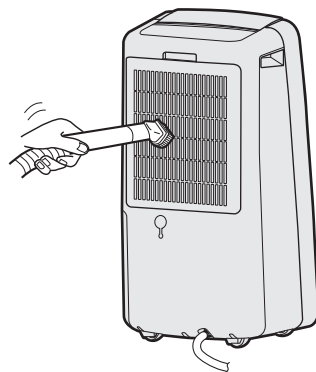

注意

如何清潔與去除污垢。

背板

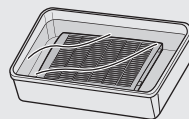

1. 將少量中性清潔劑加入水中，並浸泡大約 10 分鐘。

警示

2. 擦洗時，請勿在背板上過度施力。
3. 使用清水洗去中性清潔劑。
3. 將過濾網置於通風良好的位置以徹底乾燥。

霉菌過濾網 (大約每月一次)

清除霉菌過濾網上的灰塵。

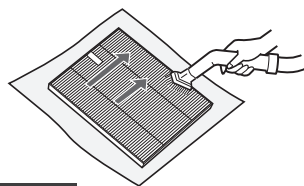

請小心清潔過濾網，勿過度施力。

警示

請勿清洗過濾網，且勿置於陽光下曝曬 (以免過濾網可能會失去功效)。

更換過濾網

過濾網之使用壽命

過濾網之使用壽命取決於房間的環境、使用條件及主機位置，可能需提早更換。

- 霉菌過濾網 開啟後大約 1 年

更換過濾網型號

若想要購買濾網進行更換時，請諮詢客戶服務中心。

霉菌過濾網 (1 塊)

FZ-J27KFE

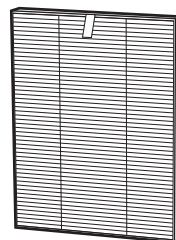

處置過濾網

請根據當地之法律和法規處置使用過的過濾網。

霉菌過濾網材質：

- 聚丙烯
- 聚乙烯

故障時的檢查事項

長時間存放不使用時

1. 以內部除濕模式運行。

- ① 開始運行。



- ② 選擇內部除濕。



- ③ 停止運行。



* 啟動內部除濕模式，大約 90 分鐘後會自動停止。

2. 倒掉儲水箱的水及清潔主機。

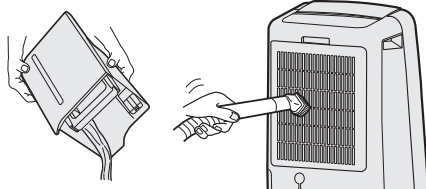

3. 存放在乾燥的位置，避免陽光直射。

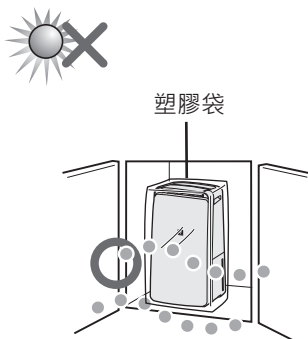

在聯絡要求維修之前，請先檢查下列事項，以確保該問題非主機故障引起。

房間變熱

- 主機在乾衣除濕運行和除濕運行期間會產生熱能，導致室溫升高。暖空氣從吹出口排出，但是此為正常現象，不代表主機有問題。

主機無法除濕

- 除濕等級會隨房間大小、結構、溫度及濕度等級而異。當室溫或濕度較低時，除濕等級通常也會降低。
- 檢查背板是否乾淨。
- 檢查吹出口或吸氣口是否堵塞。

有異常聲音

- 主機在產生離子時可能會發出咔嗒聲或滴答聲，此為正常現象。
- 主機開啟後 2 到 3 分鐘內，運行聲音比較大。這是壓縮機啟動的聲音，非常正常。
- 在主機開啟或關閉後以及運行期間，會立即聽到嗖嗖聲。這是冷媒在主機內流動的聲音。

聲音太大聲

- 室內溫度較低時，主機在開啟後數秒鐘內發出很大的聲音。
- 檢查主機是否放置在平穩的地面上。
- 檢查背板是否堵塞。

主機的濕度偵測指示燈與房間內另一個濕度計的顯示不同

- 同一個房間內的濕度等級不同。
- 感測器有不同的測量參數。

漏水

- 檢查主機是否水平放置。
- 在連續排水時，檢查軟管是否已完全插入。

顯示錯誤

如果重複出現錯誤，請聯絡客戶服務中心。

	<ul style="list-style-type: none"> 如果儲水箱滿水時，請將水倒掉。 如果儲水箱未正確放置，請正確放置儲水箱。
	<ul style="list-style-type: none"> 主機在除霜模式下運行。
	<ul style="list-style-type: none"> 乾衣除濕（自動）操作已完成，且已停止運行。
	<ul style="list-style-type: none"> 使用之自動關機功能已停止運行。
	<ul style="list-style-type: none"> 拔下主機電源插頭，等待一分鐘，然後重新插上主機電源插頭。

規格

型號	DW-P22A	
電源	220V-240V/50Hz	
抽濕能力※ ¹	30°C/80%RH	22 公升 / 日
	26.7°C/60%RH	13 公升 / 日
耗電量※ ²	30°C/80%RH	290 瓦
	26.7°C/60%RH	230 瓦
備用狀態※ ³	0.7 瓦	
抽濕面積※ ⁴	27-54 平方米	
高濃度 Plasmacluster ion 之適用面積※ ⁵	33 平方米	
儲水箱容量	約 4.6 公升	
電源線長度	約 2 米	
外形尺寸	359 毫米 (闊) × 248 毫米 (深) × 665 毫米 (高)	
重量	16.0 公斤	

※1 抽濕能力是指連續保持室溫及相對濕度於 30°C /80%RH 及 26.7°C /60%RH 時的每天抽濕量。

※2 耗電量是在最大風速下的數值。

※3 備用狀態是指將電源插頭插入電源插座後而電源開關鍵設定在關機的狀態。

※4 根據 JEMA 標準。

※5 當主機靠牆壁放置時，能於房間中央測得每 1 立方厘米大約 7000 個離子的房間大小內，以「衣物除臭」模式設定運行下，測量高度大約為離地 1.2 米。

SHARP

SHARP CORPORATION

OSAKA, JAPAN